

UNIVERSITY PARENT  
**GUIDE**

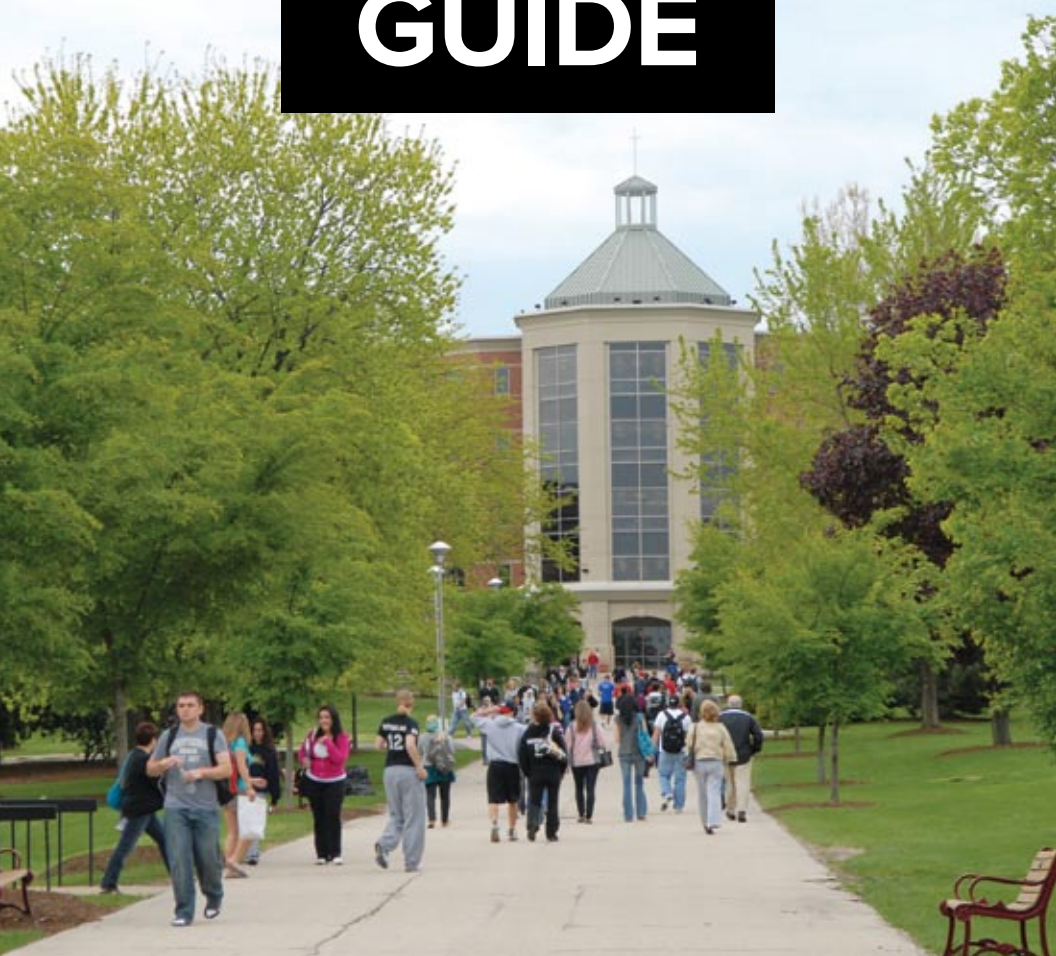

# 2010 | Benedictine University

---

CAMPUS RESOURCES – LOCAL INSIGHT – HELPFUL INFORMATION

# Two Great Lisle Communities, One Extraordinary Lifestyle



**THE TOWERS**  
At Four Lakes  
APARTMENT HOMES (888) 284-1838



**GREENTRAILS** (888) 314-4984



marquette management  
www.marquettemanagement.com

Newly Renovated Apartment Homes  
Swimming Pool | Concierge Services  
5-Star Customer Service







Starting at  
**\$79\***  
Ask for the  
BENEDICTINE  
special rate.



**Welcome to Togetherness Country.**

Nothing brings a family together like free breakfast on the ultimate road trip. Visit [countryinns.com](http://countryinns.com) to find a stay that satisfies the whole family, and we'll have you saying, "I love this Country."

Free cookies • Indoor pool & whirlpool  
Free high-speed Internet • Shuttle service



**COUNTRY  
INN & SUITES**  
BY COURTESY

I love this Country.  
1837 Centre Point Circle • Naperville, IL 60563  
800-456-4000 • 630-505-3353  
[countryinns.com/napervilleil](http://countryinns.com/napervilleil)

\* Based on availability. Subject to change without notice. Other restrictions may apply. Special offer expires 12/31/2011. Visit [www.countryinns.com/benedictine](http://www.countryinns.com/benedictine)

## TABLE OF CONTENTS

### 5 | **Benedictine Guide** Comprehensive advice, information for campus success

- 5 | Welcome to Benedictine University!
- 6 | Student Life
- 11 | Tips for Parents
- 12 | About Benedictine University, Fast Facts
- 14 | History of the University
- 15 | About the Campus
- 16 | Campus Map
- 18 | Academics
- 20 | Scholarships
- 22 | Great Teaching
- 23 | Applying to Benedictine University
- 24 | Parking, Student Employment
- 25 | Campus Safety & Security

### 26 | **Lisle Community** Make the most of your visit by getting to know the area

- 26 | Welcome to Lisle, IL!

### 28 | **Resources** Must-have knowledge to navigate your way

- 28 | Campus Emergency & Inclement Weather Information
- 30 | Helpful Contact Information
- 31 | Featured Sponsors

## Welcome!

University Parent Media works closely with institutions around the country to bring together the most relevant, timely information into one all-inclusive resource.

We have published this guide with the mission of helping you easily navigate the university and its surrounding community. Ultimately we hope these resources help nurture your connection and involvement in your student's college years!

### University Parent Media Staff

**Publisher:** Sarah Schupp

**Production:** Grace Cassara, Eric Hosmer, Brian James, Lee Riley, Jon Saints, Meg Steinborn

**Sales:** Rebecca Boozan, David Famula, Mike Gooley, Scott Griesser, Sharon Haddad, Jake Harmon, Jon Hydeman, Patricio Illanes, Kristen Seldon, Amy Travis

**University & College Relations:** Sarah Koontz

**Office Manager:** Linsey Straugh

**Follow us on:**

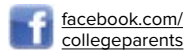

### Make the most of your Parent Guide

- Hang on to your Guide! Inside you'll find information that's useful all year long, including important phone numbers, web sites and calendars.
- Store your copy in a purse or glove compartment for convenient reference.
- Pass it along to parents of prospective college students to promote the school.
- Please recycle when finished!
- Discover more content, tips and local business information by visiting us online! (URL below)



*Informing today—  
Transforming tomorrow*

**Hope Keber**  
**Parent Liaison**  
**Benedictine University**  
**5700 College Road**  
**Lisle, Illinois, 60532**  
**(630) 829-1127**  
**[hkeber@ben.edu](mailto:hkeber@ben.edu)**

The presence of Benedictine University logos and marks in this Guide does not mean Benedictine University endorses the products or services offered by advertisers in this Guide.

Advertising Inquiries:  
(866) 721-1357  
[ads@universityparent.com](mailto:ads@universityparent.com)

©2010 University Parent Magazines, Inc.



## Welcome to Benedictine University!

Please accept this guide presented to you by the Benedictine University Parent Program. Benedictine is one of the nation's premier private universities. *U.S. News & World Report*® consistently ranks Benedictine as a top school and one of the most diverse campuses in the Midwest.

Benedictine tradition celebrates community as a gathering of people who share a commitment to a common mission. The Benedictine community is dedicated to the academic success, social development and personal growth of every student. At Benedictine, we value every student and provide the resources necessary to ensure their success.

As a parent of a new student at Benedictine, you are an integral member of the Benedictine community. Your continued support and active participation in your student's college career will ensure their success.

Thank you for sharing your children with Benedictine. It is rewarding to share in your joy and enthusiasm as they embark upon the path to a productive future.

However, there is one resource we cannot provide our students – the continuing support of their parents.

Sincerely,

**Marco Masini**  
Associate Vice President of Student Life ■

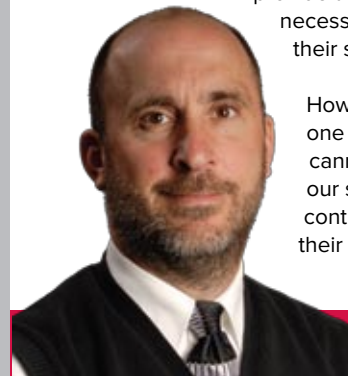



# Student Life

## Parent Program

The Parent Program offers a one-stop service for parents of Benedictine students. We respond to parent inquiries and provide information on a variety of issues to facilitate communication between parents and the University.

### Parent Association

The Benedictine Parent Association is a University-supported, volunteer led organization established to strengthen the tie between Benedictine and the families of current students by involving parents in campus activities that promote the University and enrich the undergraduate college experience. There is no cost to be a member. All Benedictine parents are automatically members. There are many opportunities for parents to get involved in the Benedictine community.

### Parent Liaison

The Parent Liaison is a dedicated staff member who responds to parent and student inquiries and provides information



and assistance on a variety of issues from admission through graduation. Please contact Hope Keber at (630) 829-1127 or [hkeber@ben.edu](mailto:hkeber@ben.edu).

### Parent Publications

- Annual Parent Calendar
- The Parents website provides information and answers general questions and concerns you may have while your son or daughter is a student at Benedictine. Visit [www.ben.edu/parents](http://www.ben.edu/parents).
- *A Message Home* is a quarterly newsletter e-mailed throughout the academic year and includes timely campus updates. This may also be used intermittently to send important messages to parents.
- Annual Parent Guide
- Facebook page for Parents of Benedictine University

## Athletics

Benedictine offers 19 NCAA Division III sports: men's football, basketball, baseball, cross country, golf, indoor and outdoor track and field, and soccer, and women's volleyball, basketball, softball, cross country, golf, indoor and outdoor track and field, soccer, tennis, dance and cheerleading. More than 350 students participate in intercollegiate sports at Benedictine University.

The Athletics Department at Benedictine seeks to prepare each student-athlete to be a champion of leadership. By establishing an atmosphere where academic distinction, personal integrity, respect for all others, community service and athletic excellence are expected, the Athletics Department strives to develop well-rounded and informed citizens who carry the Benedictine values now and throughout their lives.

The Eagle Club is an annual fundraising program that is committed to supporting Benedictine athletics. In accordance with the policies and procedures of the NCAA, the fund was established in response to the rising expenses of operating an athletic department. The Eagle Club is a board-based group of alumni, community supporters and friends of Benedictine athletics who assist in the University's commitment to excellence. Membership provides a number of incentives including: Eagle Club social events before and after athletic contests; an Eagle Club golf outing; tailgating opportunities; club suite events and more.

## Barnes & Noble Bookstore

Barnes & Noble at Benedictine University is located on the first floor of the Krasa Student Center. Offering a wide range of textbooks, reference material and collegiate apparel, the bookstore offers a number of conveniences and even has a textbook buy-back program. Students may make textbook reservations for the upcoming term by visiting [www.whywaitforbooks.com](http://www.whywaitforbooks.com).

## Career Development

Career Development at Benedictine provides job search assistance to students and alumni seeking full-time, part-time and internship positions. Benedictine is committed to the principles of equal employment opportunity and students are referred without discrimination on the basis of race, color, sex, religion, age or national origin.

Career counselors meet with students to discuss opportunities, prepare resumes, and establish goals for what students need and want to learn. A career service library houses all career-related information for easy access by Benedictine students. ►

## Dining Services

The Krasa Center Dining Room, the Coal Ben and the Kindlon Hall Coffee Shop are brought to you by Sodexo Campus Services and the dining team at Benedictine. The Dining Services team at Benedictine is always striving to bring new and improved types of service to our guests. There is a variety of meal plans from which to select for students who reside in residence halls, campus apartments or commute from off-campus.

## Housing and Residence Life

Benedictine considers residential life an important element of the college experience and offers a variety of housing options: all-male, all-female or co-educational residences in a mix of residence hall rooms, suites and apartments.

Ondrak Hall, located on the south end of campus, is an all-male smoke-free hall that houses up to 160 students. Ondrak features carpeted rooms with a relaxing lounge on the first floor. A computer lab with Internet access and a printer is available on the second floor.

Jaeger Hall is an all-female smoke-free hall that can house up to 150 students on four floors. Located next to the Krasa Student Center in the heart of campus, Jaeger features a computer lab with Internet access and free laundry facilities on the lower level.

Neuzil Hall, an upper-classmen coeducational residence facility, is located at the northern end of campus and features 44 suite-style rooms each housing three students. Each suite is carpeted, curtained and painted and consists of two bedrooms and one bath with a shower.



## Student Activities

Students can choose from more than 40 different organizations for extracurricular activities – each with a faculty advisor and often formed around mutual interests such as the *Candor* (student newspaper), the Political Science Student Organization (which often hosts candidates' forums and brings other political figures to campus) and the Tri-Beta Biology Club.

Other student organizations include the Investment Club, which manages more than \$100,000 of the University's endowment while teaching students responsible investment; Model United Nations, one of the University's most decorated extracurricular organizations; Best Buddies, which enhances the lives of people with mental retardation by providing opportunities for one-to-one friendships and integrated employment; and Club 350, a group that seeks to protect the environment.

A complete list of student organizations can be found at [www.ben.edu/studentactivities](http://www.ben.edu/studentactivities).

Benedictine is also committed to community service. The University was named to the President's Higher Education Community Service Honor Roll for its participation in a range of volunteer activities during the 2009-2010 school year, including the American Cancer Society Relay for Life and "Sustainable Saturday," a recycling event that collected more than 109,000 pounds of used electrical equipment. Students also help neighboring communities by offering tax preparation services for low-income citizens and seniors.

Benedictine is one of only five colleges and universities nationally selected to participate in the U.S. Department of State's Middle East Partnership Initiative Study of the United States Institutes for Student Leaders, a six-week program designed to familiarize students from the Middle East and North Africa with American culture and institutions. ►

## Student Health Services

The goal of Student Health Services is to assist students in maintaining an optimal level of good health in hopes that they will reach their full potential as a student and get the most out of their college experience. Student Health Services does not replace the family doctor but rather provides assessment and treatment that is both convenient and cost effective, thus allowing students minimal time away from campus activities.

## Student Success Center

The Student Success Center supports students' academic, personal and



professional development through resources and services which serve to maximize their academic success, enhance their student experience and better prepare them for further study or the workforce.

The Center engages students by providing support for academic work as well as co-curricular activities and professional goals.

The Student Success Center's services include:

- Academic support and tutoring functions
- Accommodations services for students with disabilities
- Advising and related support for undecided majors, students on academic probation and continuing probation
- Leadership development
- Supplemental education and service learning
- Comprehensive career development services, including assessment, internship services, career education programs, job search functions and career resources

The Student Success Center is located on the lower level of the Krasa Student Center.

## University Ministry

University Ministry is an integral part of student development and campus life at Benedictine. We offer programs and services that assist in the spiritual growth of our students, staff and administration. We celebrate the diversity of faiths at Benedictine. All are welcome and highly encouraged to become involved in the many opportunities in ministry. University Ministry is located in the Krasa Center on the main floor, and is always open. ■

## The Summer Before Freshman Year Tips for Parents

- **Let your children know it is natural to have doubts, to be unsure what their major will be or how they will adapt to college life. Express trust in your child's ability to make the right choices when the time comes.**
- **Don't overreact to mood changes or seemingly irresponsible behavior. Your child's anxiety about the first year of college might be the cause.**
- **You know your child best; if mood changes are excessive and if depression is the prevailing mood, seek the help of professionals. Counseling might put this big transition in your child's life into perspective.**
- **Focus on important matters. Talk with your child about four major topics: academic expectations, money matters, social choices and communication.**
- **Guide, don't direct. Rather than expressing your opinion about the best careers or academic choices, ask your child probing questions. When our children own their decisions, they will grow and mature. ■**

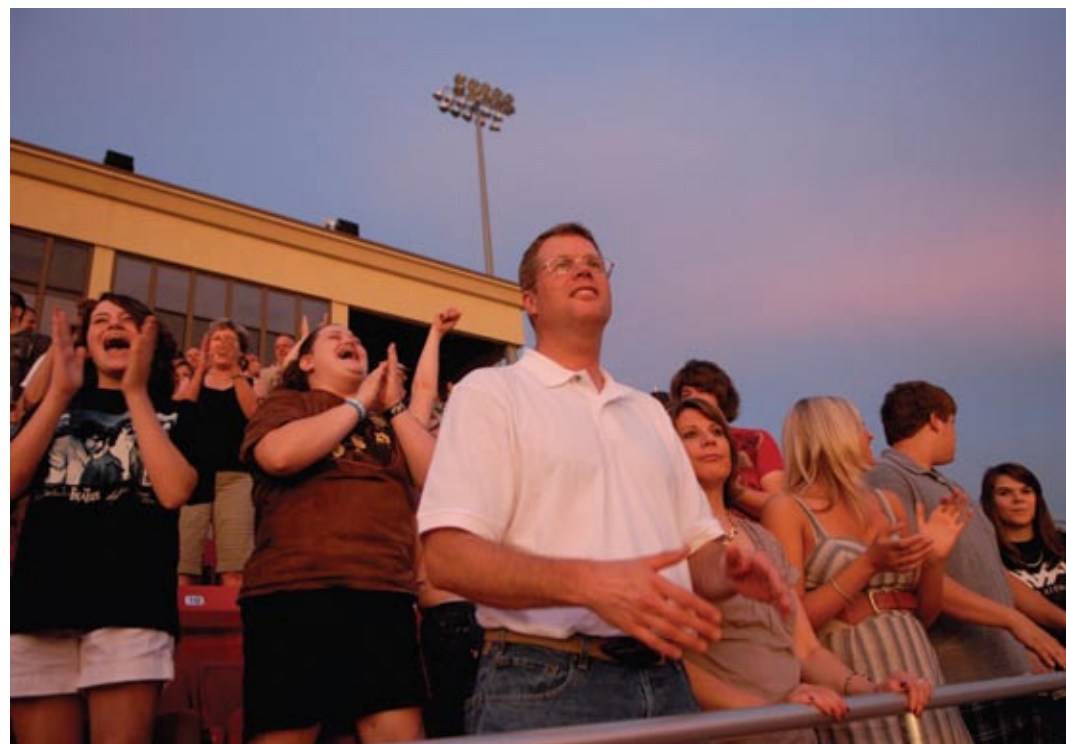

# About Benedictine University

As an academic community committed to liberal arts and professional education — distinguished and guided by its Roman Catholic tradition and Benedictine heritage — Benedictine University prepares its students for a lifetime as active, informed, and responsible citizens and leaders in the world community.

A Benedictine education is designed to be flexible so that it can meet current social needs, developing in its graduates the capacity to adapt as they enter the working world, and the ability to manage change and difficulties in a confident and positive manner. Benedictine fulfills its commitment to its mission through excellence in teaching and interaction between students and faculty.

A liberal arts core prepares all undergraduate students to participate fully in a diverse and dynamic society, balancing their rights and duties as individuals with the demands of the common good.

However, Benedictine seeks to develop more than a student's intellectual being. Members of the Benedictine community are encouraged to achieve a balance in their social and educational lives.

Benedictine students come to understand the self as an integrated physical, intellectual and spiritual being. While the University values the dignity of work, it recognizes that balance with leisure and prayer is equally important.

Living a life in balance helps to enrich one's personal life while fostering friendships and relationships that can span a lifetime. ■



## Fast Facts

### Students (2009)

- 8,874 total University enrollment
- 3,355 undergraduates from 49 states and 16 foreign countries
- 31.4 percent of all students are minorities (voluntarily reported). 1.1 percent is international students.
- 40 student organizations, honorary societies, service groups, ethnic associations and a student newspaper
- 48 percent of students indicate a religious preference; of those 15 percent indicate they are Muslim (same as 2008-09)

### Faculty (2009-2010)

- 93 full-time faculty; 80 percent hold a terminal degree in their field; 16:1 student-to-faculty ratio; average class size is 17.

### Athletics

- 2009-2010 Northern Athletics Conference women's volleyball regular-season champions
- \$10 million Village of Lisle-Benedictine University Sports Complex completed in 2005
- Hosted 2006 NCAA Division III Outdoor Men's and Women's Track and Field Championships
- NCAA Division III affiliation offering 19 men's and women's sports
- School nickname: Eagles
- School mascot: Ernie the Eagle

### Undergraduate Tuition, Room and Board (2010-2011)

- Tuition (traditional undergraduate): \$22,500 per year
- Mandatory fees: \$710 per year
- Residence halls room and board average: \$7,257 per year
- Apartments room and board average: \$8,065

- Tuition (adult accelerated undergraduate): \$490 per credit hour
- 86.5 percent of full-time undergraduates received financial aid. Average award \$14,133.

### Graduate Tuition (2010-2011)

- Per quarter credit hour: \$510
- Per semester credit hour: \$750

### Undergraduate Financial Aid and Scholarships (2009-2010)

- \$12,412,402 million of annual budget is directed to grants and scholarships
- 96 percent of freshmen receive some form of financial aid
- Average financial aid package for freshmen is \$15,842

### Alumni

- More than 18,800 alumni in 50 states, Puerto Rico and Guam
- More than 280 alumni in 21 countries including China ■

# History of the University

**Benedictine University bears the name of St. Benedict, born in 480, who is acknowledged as the father of Western monasticism. In 528 he established the famed monastery of Monte Cassino. In the middle Ages, Benedictine monasteries expanded all over Europe, preserving ancient learning and written languages.**

Benedictine was founded in Chicago as St. Procopius College by the Benedictine monks of St. Procopius Abbey in 1887. It secured a charter from the state of Illinois in 1890. The College was founded to educate men of Czech and Slovak descent, and most students were of Czech ancestry in the early years.

In 1901, the College moved to the more congenial atmosphere of Lisle, in DuPage County. The first building, Benedictine Hall, was dedicated in September 1901. The building was completed by 1921 and new buildings began to be added after 1926. The College became coeducational in 1968 and was renamed Illinois Benedictine College in 1971.

In response to community needs, graduate, doctorate and adult learner programs were added. The College became Benedictine University in 1996.

Partnerships have spurred the University's growth in the 21st century. In 2003, Benedictine and Springfield College in Illinois partnered to bring Benedictine programs and services to central Illinois. Benedictine University at Springfield now offers a growing range of programs in Illinois' state capital.

In 2004, Benedictine partnered with Shenyang University of Technology and Shenyang Jianzhu University in China to bring Master of Business Administration and Master of Science in Management Information Systems programs overseas.



Benedictine has since partnered with several institutions in Vietnam.

Also in 2004, the University partnered with the Village of Lisle in the construction of The Village of Lisle-Benedictine University Sports Complex, a multi-purpose facility featuring lighted athletic fields with a nine-lane track.

Benedictine opened the Margaret and Harold Moser Center in Naperville in 2006 to meet the needs of adult students and area businesses.

Benedictine University belongs to the Association of Benedictine Colleges and Universities, an organization that promotes the Benedictine traditions of education and hospitality. ■

# About the Campus

**Benedictine University is situated on a rolling, tree-covered 108-acre campus of 20 buildings with air-conditioned classrooms and modern, well-equipped laboratories. A comprehensive learning center with full media library and a modern and technically advanced science facility, filled with laboratory space, digital classrooms and research equipment opened in fall 2001.**

A student athletic center features a new hardwood basketball court with surrounding track surface, three tennis courts and training facilities. The Village of Lisle-Benedictine University Sports Complex, which was completed in 2005, provides top quality football, soccer, and lacrosse, track, and softball and baseball fields. In 2006, the complex was the site of the NCAA Division III Men's and Women's Outdoor Track and Field Championships.

Other campus features include a scenic campus lake, a student center with a dining room, chapel, bookstore and meeting rooms.

As part of the University's ongoing capital improvements, construction of a parking garage designed to accommodate 400 vehicles began in summer 2010 while the Rice Center, the University's athletic facility, was slated to undergo a facelift that includes a student health and fitness center. ■



*Love Where You Live.*

The Villages on Maple is worth discovering and offers an exciting array of apartments and town homes that you will be proud to call home. Located in a welcoming, serene neighborhood within Lisle, The Villages on Maple is just minutes away from I-355, I-88, Metra, Pace bus services, schools, shopping, entertainment and much more! At The Villages on Maple you can enjoy maintenance free living, a 24-hour fitness center, a business center, and a refreshing outdoor pool. Your future starts here!

Come and see your new home today!

\$0 Security Deposit

Pet Friendly

On-Site & In-Unit W/D Available

Flexible Lease Terms

Please Call for Current Pricing & Availability



**THE VILLAGES ON MAPLE**

1769 Robin Lane - Lisle, IL 60532

**(630) 969-6540**

[www.villagesonmaple.com](http://www.villagesonmaple.com)

# Benedictine University Campus Map

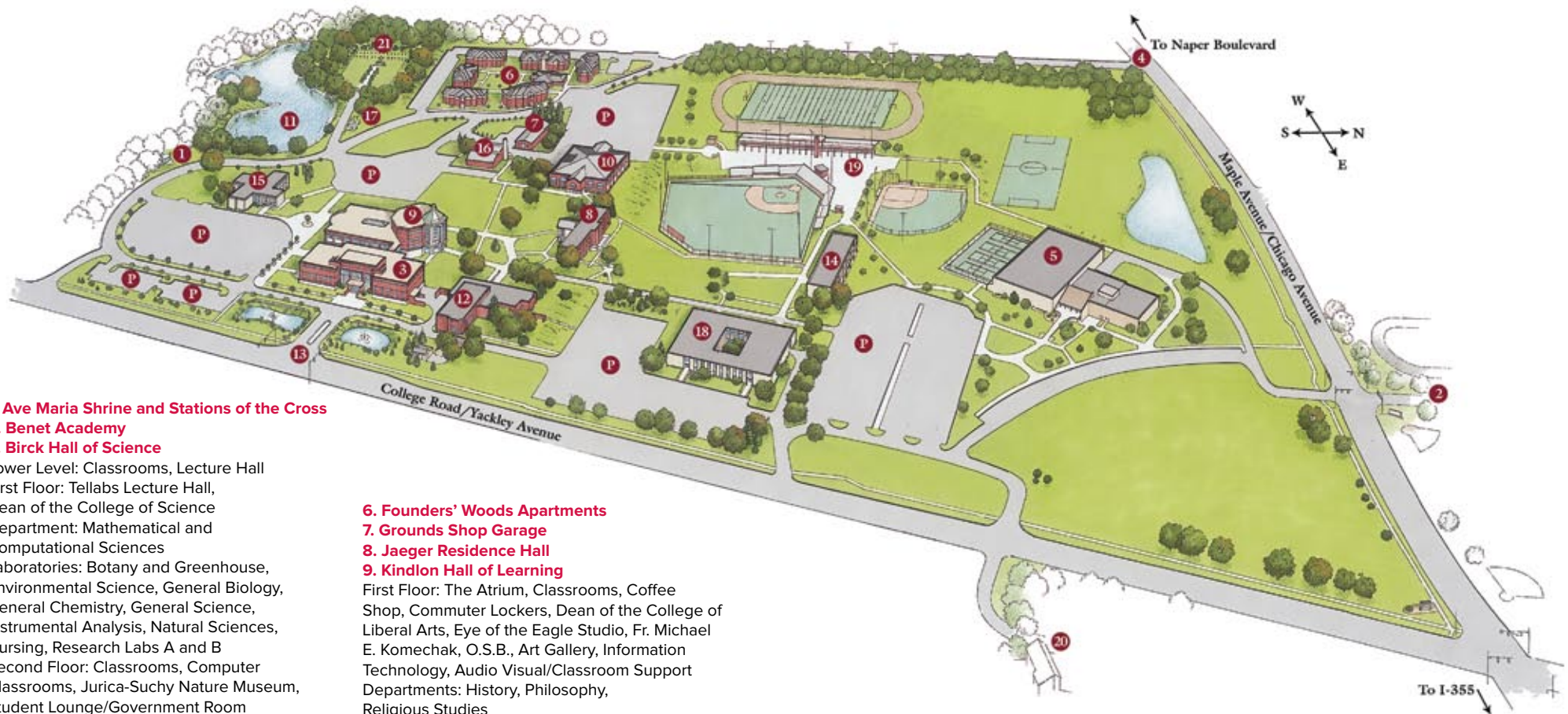

## 1. Ave Maria Shrine and Stations of the Cross

### 2. Benet Academy

### 3. Birck Hall of Science

Lower Level: Classrooms, Lecture Hall

First Floor: Tellabs Lecture Hall,

Dean of the College of Science

Department: Mathematical and Computational Sciences

Laboratories: Botany and Greenhouse, Environmental Science, General Biology, General Chemistry, General Science, Instrumental Analysis, Natural Sciences, Nursing, Research Labs A and B

Second Floor: Classrooms, Computer Classrooms, Jurica-Suchy Nature Museum, Student Lounge/Government Room

Laboratories: General Physics and Electronics, General Science, Nutrition

Third Floor: Cold Room, Tissue Culture Room

Departments and Programs: Biochemistry and Molecular Biology, Biological Sciences, Chemistry, Clinical Exercise Physiology, Physics and Engineering, Science Content and Process, Pre-Professional Health Laboratories: Anatomy, Biochemistry, Biomechanics, Cell Biology, Genetics, Instrumental Analysis, Microbiology, Organic Chemistry, Physical Chemistry, Physiology, Research Labs C-I, Research Techniques, Senior Physics

### 4. Campus Delivery Entrance

### 5. Dan and Ada Rice Center

Basketball Arena, Classrooms, Coaches Office, Indoor Track, Racquetball/Tennis Courts, Trophy Room, Volleyball Arena

## 6. Founders' Woods Apartments

### 7. Grounds Shop Garage

### 8. Jaeger Residence Hall

### 9. Kindlon Hall of Learning

First Floor: The Atrium, Classrooms, Coffee Shop, Commuter Lockers, Dean of the College of Liberal Arts, Eye of the Eagle Studio, Fr. Michael E. Komechak, O.S.B., Art Gallery, Information Technology, Audio Visual/Classroom Support  
Departments: History, Philosophy, Religious Studies

Second Floor: Benedictine Library Entrance, Classrooms, Computer Classrooms, Registrar's Office, Dean of the College of Education and Health Services

Departments: Communications, English Language and Literature, Foreign Language, Health Services, Public Health, School of Education

### 10. Krasa Student Center

Art Gallery, Bookstore, Career Development, Dining Room, Enrollment Services (registration/financial aid/student accounts), Health Services/Counseling, International Center, Mail and Copy Center, Meeting and Seminar Rooms, Moser Fireside Lounge, Presentation Room, University Police, Switchboard, Residence Life, St. Benedict Chapel, Student Activities, Student Life, Student Success Center, University Ministry

## 11. Lake St. Benedict

### 12. Lownik Hall

Enrollment Center, Admissions, Auxiliary Enterprises, Benedictine Fund, Business and Finance, Campus Services, Community Development, Financial Aid, Information Technology, Marketing and Communications, New Student Advising Center, Personnel Resources, Research and Development, Student Accounts

### 13. Main Entrance

### 14. Neuzil Residence Hall

### 15. Ondrak Residence Hall

### 16. Coal Ben and Powerhouse

### 17. Jurica Tallgrass Prairie

### 18. Scholl Hall

First Floor: Administrative Suite, Alumni Relations, Classrooms, Dean of the College of Business, Faculty Offices, University Development

Departments: Business and Management, Computer Science, Fine and Performing Arts, Information Systems, Management and Organizational Behavior, Organization Development  
Second Floor: Computer Lab, Classrooms, University Events  
Departments: Anthropology, Business Administration, Clinical Psychology, Economics, International Business, Political Science, Psychology/Sociology

19. The Village of Lisle – Benedictine University Sports Complex

### 20. St. Procopius Abbey

### 21. St. Procopius Abbey Cemetery

### P Parking



## Academics

Benedictine offers 53 undergraduate majors through the College of Science, the College of Liberal Arts, the College of Business, the College of Education and Health Services, and the Moser College of Adult and Professional Studies. The most popular majors are management, health science, biology, psychology and elementary education.

Benedictine has a reputation for providing a solid education in science. Students have the opportunity to participate in research projects using the latest technology such as the Modulus Single Tube Fluorometer, a multifunctional instrument that helps chemistry students quantify the amount of various chemical compounds and biological macromolecules in samples, and a DNA sequencer, which enables students to investigate the structural information encoded in the human genome.

Benedictine's broad-based liberal arts program creates well-rounded students because the University believes that even if students pursue a career in science, they should be able to read, write and speak well. Benedictine graduates contribute to and are functional members of society, making a difference in the world.

There are three options for education abroad. Students can enroll in partner institutions through Partnership Exchange Programs, or they can participate in programs offered by third parties or in programs developed by Benedictine faculty.

During school breaks, business students travel to Tijuana, Mexico to see the consequences of business decisions made in the United States. They study poverty, urban development, human rights, manufacturing, industrial facilities, working conditions and the impact of NAFTA. Students have also visited China, Japan, France, Spain, Korea, Ireland and Denmark. Alternative Spring Breaks are popular, and students have traveled to Louisiana to rebuild homes destroyed by Hurricane Katrina and to Bolivia to help in orphanages, hospitals and day-care centers. ■



STAY CONNECTED TO BENEDICTINE UNIVERSITY WITH THE

## BENEDICTINE | ONLINE UNIVERSITY | GUIDE

[www.universityparent.com/ben](http://www.universityparent.com/ben)

The online version of this guide includes even more local information and tools to plan your next trip to campus:

- "Book Now" Accommodations
- Attractions
- Dining
- Shopping & Retail
- Transportation & Maps
- Parent Resources & Services



 UNIVERSITY PARENTmedia

# Scholarships

Benedictine University offers several automatic scholarships for students who meet the criteria. Our unlimited merit-based scholarships for full-time students are based on a cumulative GPA. We also recognize underrepresented minorities, children of alumni and graduation from a Catholic high school.

## Presidential Award

*Amount:* \$7,150 - \$11,500 per year  
*Eligibility:* Evaluation of standardized test scores, high school class rank and cumulative GPA for incoming freshmen.  
*Renewability:* Cumulative GPA 3.0/4.0; Full-time enrollment

## St. Benedict Award

*Amount:* \$4,700 - 7,000 per year  
*Eligibility:* Evaluation of standardized test scores, high school class rank and cumulative GPA for incoming freshmen.  
*Renewability:* Cumulative GPA 2.75/4.0; Full-time enrollment

## Benedictine Eagle Award

*Amount:* \$2,300 - 4,100 per year  
*Eligibility:* Evaluation of standardized test scores, high school class rank and cumulative GPA for incoming freshmen.  
*Renewability:* Cumulative GPA 2.5/4.0; Full-time enrollment

## Opportunity Award

*Amount:* Up to \$3,000 per year  
*Eligibility:* Graduate from a high school with more than one-third of the student population considered to be "low-income" families. Qualifying high schools will be determined by the "Teacher Cancellation Low Income Directory" published by the United States Department of Education.  
*Renewability:* Full-time enrollment

## Catholic High School Recognition Award

*Amount:* Up to \$2,000 per year  
*Eligibility:* Graduate of a Catholic high school  
*Renewability:* Full-time enrollment

## Alumni Recognition Award

*Amount:* Up to \$1,000 per year  
*Eligibility:* Son or daughter of a Benedictine University alumnus  
*Renewability:* Full-time enrollment

## Out-of-State Award

*Amount:* Up to \$5,000 per year  
*Eligibility:* Given to students who are residents of a state other than Illinois and who will reside on campus while attending the University  
*Renewability:* Full-time enrollment

## Sibling Recognition Award

*Amount:* Up to \$1,500  
*Eligibility:* Given to incoming students ONLY with currently enrolled or alumni sibling  
*Renewability:* Full-time enrollment

## Leadership Award

*Amount:* \$1,500 per year  
*Eligibility:* Participated in high school leadership roles  
*Requirements:* Resume and letter of recommendation from the Faculty Advisor for the club/organization you participated in over your high school career  
*Renewability:* Full-time enrollment

## Honors Society Award

*Amount:* \$1,000 per year  
*Eligibility:* Active member of a nationally accredited honors society  
*Requirements:* Resume and a copy of the induction letter to the honors society or the Faculty Advisor of the honors society  
*Renewability:* Full-time enrollment



## Benedictine Spirit Award

*Amount:* \$1,500 per year  
*Eligibility:* Active role in the community by reaching out and volunteering to help others  
*Requirements:* A short essay that explains the work or project completed and a letter of recommendation from a project supervisor or Faculty Advisor  
*Renewability:* Full-time enrollment

## Music Scholarship

*Amount:* Up to \$4,000  
*Eligibility:* Successful completion of a music audition with the music department; Declared major or minor in music; Full-time status in undergraduate program  
*Renewability:* Maintain a 3.0/4.0

cumulative GPA; Enroll in at least one music course per semester with music department advisor approval

## Scholars Program Award

*Amount:* \$12,600 per year  
*Eligibility:* Awarded by the Scholars Program selection committee to a limited number of incoming students; Not applicable to students in pre-nursing or pre-pharmacy programs. Freshman students must have a minimum 3.75/4.0 cumulative GPA, a 27 ACT or 1210 SAT and two years of foreign language at the high school level.  
*Renewability:* Maintain 3.2/4.0 cumulative GPA. Full-time enrollment in the Scholars Program. ■



- Newly renovated kitchens & bathrooms with new cabinets, countertops and flooring\*
- Spacious walk-in closets\*
- Controlled access entry
- Garage parking available\*
- Pets welcome - Certain breed restrictions apply
- Newly finished sundeck and refreshing pool
- Short-term lease options
- 24-hour Emergency maintenance
- Championship hard top tennis courts
- Amazing shopping, dining, and entertainment at the Promenade in Bolingbrook & Oak Brook Center
- Close to Metra train station
- Perfect location! Easy access to I355, I88, and I55

\* In select units

NEWLY REMODELED  
 IMPRESSIVE FLOORPLANS  
 COMFORTABLE LIFESTYLE  
 BEAUTIFUL COMMUNITY

**STUDENT DISCOUNTS**

**prentiss creek**  
*at Downer's Grove*

2110 Prentiss Dr - Downers Grove, IL  
**630.964.6084**  
[www.prentisscreekapartments-prg.com](http://www.prentisscreekapartments-prg.com)



## Great Teaching

**Benedictine is grounded in the spirit of the founders, who based their lives and work on St. Benedict's Rule for Monks, written in the early sixth century. The University builds its educational life on the values of the Benedictines, including the central celebration of community as a gathering of people who share a commitment to a common mission.**

A liberal arts core prepares all undergraduate students to participate fully in a diverse and dynamic society, balancing their rights and duties as individuals with the demands of the common good. Benedictine's core curriculum unites all students with a shared base of broad knowledge. Each student must take courses covering basic skills, enroll in a freshman seminar and choose from a series of courses about cultural heritage.

Benedictine teachers are committed and accomplished. Faculty is frequently honored with local, regional, national, and international grants, fellowships and awards. Many of these grants create opportunities for students to participate in ground-breaking research projects.

Benedictine's students take their studies seriously, and the low student-to-faculty ratio of 16:1, combined with an average class size of 17, allows students to enjoy a close familiarity with professors. Students take advantage of the faculty's open office hours, and professors reach out to get students involved.

The Center for Educational Policy Research (CEPR) at the University of Oregon recently recognized two Benedictine courses — General Chemistry I Lab and General Chemistry II Lab — for reflecting the best of college teaching. Specific elements of the course were also designated as exemplary. ■

# Applying to Benedictine University

**High school students planning to apply to one of Benedictine's traditional undergraduate programs can apply in one of three ways:**

1. Apply online at [www.applyweb.com/apply/ben/menu.html](http://www.applyweb.com/apply/ben/menu.html). It is easy and you can pay the application fee via credit card or electronic check. Official transcripts and other required documents must be mailed to the Enrollment Center.
2. Download the Undergraduate Degree Programs Application at [www.ben.edu/admissions/freshmen/ugapplication.pdf](http://www.ben.edu/admissions/freshmen/ugapplication.pdf) and mail it along with official transcripts and other required documents.
3. Have an application mailed to your home by contacting the Enrollment Center at (630) 829-6300.

Benedictine offers rolling admission into all of its programs, which means that applications are accepted and admissions decisions are made throughout the year. Once a completed admission file is received, it will take approximately 24-48 hours to process. An admissions counselor will call as soon as any documentation is received in our office.

**Be sure to complete the following checklist to ensure your admission file is ready for review.**

1. Completed application
2. \$40 non-refundable application fee
3. Official academic transcripts
4. Official academic ACT or SAT test scores
5. A letter of recommendation from your high school counselor
6. A personal statement of 200-300 words, double-spaced, answering the question, "What are your academic strengths and how will they help you at Benedictine University?" If you meet the admission requirements for Benedictine University, which are a 2.5/4.0 cumulative GPA, 21 ACT/990 SAT, and being at the top 50 percent of your graduating class, a personal statement is not required.

Please call the Enrollment Center at (630) 829-6300 for more information. ■

**Call Today and Ask for the Benedictine University Rate!**

courtyard by Marriott®  
Chicago Naperville  
Naperville, IL  
T 630.505.8337

IT'S A NEW STAY.™

# Parking

All student vehicles must be registered with the Benedictine Police Department, which is located on the lower level of the Krasa Student Center.

The Benedictine Police Department also issues employee, temporary and visitor permits. A parking permit must be properly displayed in the vehicle.

The registration of a vehicle and obtainment of a parking permit does not ensure the availability of a parking space, but rather grants the privilege of parking on campus.

Visitor passes are issued for one day for the convenience of those visiting Benedictine. Anyone inviting a visitor to campus is encouraged to obtain a pass within an hour of that person's arrival on campus. All visitors displaying a pass may park in the faculty/staff lots or in student areas.

Parking spaces that are red striped are for faculty and staff. This is enforced Monday-Friday, 7:00 a.m.-4:00 p.m. After 4:00 p.m., there is open parking.

Overnight parking is permitted in the Coal Ben and Neuzil lots only. Vehicles will be ticketed between 2:00-5:00 a.m. in all remaining parking lots. ■

# Student Employment

Benedictine provides students with a number of on-campus employment opportunities whether they want to build their resumes or help pay their college bills. On-campus jobs are student-friendly opportunities to work manageable hours and earn a little extra money. The hours are usually flexible, and students are able to work around their class schedules.

The biggest advantage to working on campus is convenience. Students are able to schedule work around their class schedules and do not have to expend any money they could otherwise be saving to drive to their jobs. On-campus employment also allows students to work with faculty, staff and other students and become more familiar with other members of the campus community.

All interested students are urged to apply for on-campus employment. However, some positions are limited to Federal Work Study-eligible students. Federal Work Study is a need-based, federally-funded program assisting undergraduate and graduate students to help meet their educational expenses. Students must complete a Free Application for Federal Student Aid (FAFSA) to determine if they are eligible for Federal Work Study programs.

Students may apply for positions at any time. On-campus positions are available throughout the year. Students interested in on-campus employment should visit [www.ben.edu/about/employment](http://www.ben.edu/about/employment). ■

# Campus Safety & Security

**Benedictine University is committed to the safety of all faculty, staff, students and visitors to our campus. Safety on campus is the result of cooperation between many Benedictine resources.**

## Benedictine University Police

Benedictine University Police officers come from both municipal and college/university police agencies. They are certified police officers who have full police powers including arrest. Our police officers bring specialized training and experience to Benedictine, which allows them to provide strong service and mentoring relationships with students. Benedictine police officers are familiar with the daily trials and tribulations students may face while attending the University. They are here to help in any way they can, whether a student needs an escort across campus, someone to help them get into their locked vehicle or just someone to talk to. Benedictine Police are here to make a student's experience safe and positive. Learn more on the University Police Web site at [www.ben.edu/police](http://www.ben.edu/police).

We encourage students to take basic safety precautions to protect themselves, their friends and their property. We have very few reported incidents of crime on campus and in our residence halls. Learn more about Benedictine's campus crime rates by visiting the U.S. Department of Education Web site at [www.ope.ed.gov/security](http://www.ope.ed.gov/security).

To increase student safety, all residence halls have ID card readers requiring students to swipe their cards to gain entrance. The residence halls also have security cameras which are monitored 24/7 by University Police emergency dispatchers and record all persons entering and leaving. A "Knock and Lock" program in the residence halls reminds

students to keep their doors locked to prevent theft and personal harm. There are emergency call buttons located inside each apartment in Founders' Woods. Emergency telephones are also located throughout campus. Students are also encouraged to check the monthly Benedictine University Police newsletter which is e-mailed to all campus community members.

## Early Alert Team

The mission of the Early Alert Team (EAT) is to provide early intervention and prevention for students who are experiencing distress, engaging in harmful or disruptive behaviors, or who have been identified as at risk. The EAT serves as a point of referral for faculty, staff members, students and/or parents who are concerned about the physical, emotional, academic or financial health of a University student. The EAT can assess the situation, offer support and provide referrals to the appropriate resources on and off campus. ■



# Welcome to Lisle, IL!

## Lisle welcomes you!

Lisle offers the finest in meeting and hotel facilities, fabulous shopping and dining, and beautiful natural surroundings. The Village of Lisle's long history of creating green spaces and our current Green by Choice initiatives make Lisle the perfect destination.

Home to The Morton Arboretum, a naturally green, 1700-acre oasis of magnificent trees and colorful gardens, you will discover that Lisle is the perfect place to relax with friends, take in a concert under the stars or simply appreciate the unique beauty brought by each season.

Enjoy annual family events like the Eyes to the Skies Balloon Festival, Polar Express Santa Train and The Morton Arboretum's Steve Tobin exhibition, Steelroots. Choose to play a round of golf at the scenic River Bend Golf Course or enjoy a great day making waves at Sea Lion Aquatic Park.

Be sure to visit our website [StayInLisle.com](http://StayInLisle.com) for special hotel packages, Lisle's Green Directory, calendar of events and much more.

## Enjoy your Stay In Lisle,

**Priscilla Tomei**  
Executive Director  
Lisle Convention & Visitors Bureau ■



*Harrison House B&B*



26 N. Eagle St. Naperville, IL  
630-420-1117  
[www.harrisonhousebb.com](http://www.harrisonhousebb.com)

*Walk to great shops & dining, the train,  
& Riverwalk.*

**Mention ad for 20% OFF.**



You Could Live  
Within Walking  
Distance of  
Campus!

630-322-9700  
630-322-9795 FAX  
[www.abbey4lakes.com](http://www.abbey4lakes.com)  
you can also e-mail us at:  
[info@abbey4lakes.com](mailto:info@abbey4lakes.com)  
Hours: Mon - Fri 9-6  
Saturday 10-5

**ABBHEY**  
APARTMENTS  
at Four Lakes  
5550 Abbey Dr #1B  
Lisle, IL 60532

# Campus Emergency & Inclement Weather Information

There is always a chance that an emergency and/or disaster could occur on the Benedictine University campus. Benedictine's Emergency Response and Recovery Team (ERRT) has developed an Emergency Response and Recovery Plan with the sole purpose of preparing the University community for the event of an emergency or a disaster. A copy is distributed to students, faculty and staff and also hangs in every campus classroom. Learn more about the plan on the University's Emergency Information Web site at [www.ben.edu/news/emergency\\_info.asp](http://www.ben.edu/news/emergency_info.asp).

The ERRT also coordinates annual fire drills campus wide during the first week of fall classes to familiarize all campus community members with what to do in the event of a fire.

The ERRT alerts the campus through a combination of methods, recognizing that no one communication mechanism will reach everyone. Emergency communications include, but are not limited to, e-mail, the University Web site, the Chicago area Emergency Closing Center, campus building alarm systems, the AlertWave™ public address system and the BenAlert emergency notification system.

Under extreme circumstances, classes may be cancelled due to severe weather, particularly during the winter months when a snowstorm may make driving hazardous. The decision as to whether classes should be cancelled will be made by 6:30 a.m.

Notification of class cancellations will be made on the following radio stations: WGN-720 AM and WBBM-780 AM. The following television stations will also have announcements: WBBM-TV CBS Channel 2, WMAQ-TV NBC Channel 5, WLS-TV ABC Channel 7, WGN-TV 9, Fox-32 and CLTV. Class cancellations will also be announced on the University website at [www.ben.edu](http://www.ben.edu).

Occasionally, a campus emergency will arise requiring the cancellation or

rescheduling of classes. Benedictine University's new "BenAlert" emergency notification system is designed to take the uncertainty out of emergencies.

The BenAlert system enables students to receive alerts (short messages about an urgent or immediate situation) and notifications (follow-up messages that may contain more detailed information that are not as time-sensitive) within minutes by phone, text and/or e-mail messages regarding emergency situations affecting Benedictine.

BenAlert enables the ERRT to schedule and send personalized voice messages to up to six phone numbers per student, and immediately sends messages via four different modes of communication from (630) 829-6622 and/or BenAlert ERRT:

- Voice messages to home phones, work phones, cell phones and even e-mail addresses;
- Text messages to cell phones, PDAs, networked digital signage and other text-based devices;
- Text messages to e-mail accounts;
- Messages to TTY/TDD receiving devices for the hearing impaired.

A student's first and last name and primary phone number that exist in Benedictine's Peoplesoft system have already been entered into the

BenAlert system as "BenAlerts" and "Notifications 1." Students may wish to add parents or other interested parties as additional contacts if they want them to receive alerts.

However, a student must go into Peoplesoft's self-service portal through MyBenU at [www.ben.edu/mybenu](http://www.ben.edu/mybenu) to confirm or update their information, add additional contact information or opt out of this service (although University policy requires at least one contact phone number be in the system for each student). ■



**WINDSCAPE**  
OF NAPERVILLE  
**APARTMENT HOMES**

Minutes to Benedictine University  
 Stainless Steel Appliances\*  
 Multi Million Dollar Renovations  
**877-526-9518**

[www.windscapenaperville.com](http://www.windscapenaperville.com)

\* Select Homes. Some restrictions apply. Please see an agent for complete details. Co-signers accepted.

## ATTENTION PARENTS AND STUDENTS IN NEED OF OFF-CAMPUS HOUSING

You asked for it, you got it! The Huntington of Naperville offers affordable condominium rentals ideally suited for students attending Benedictine University. We're just moments from campus, we offer flexible lease options and feature a variety of unit styles and sizes to suit all of your housing needs. Come discover why other Benedictine students and faculty already call Huntington home!

Condominiums also available for purchase.

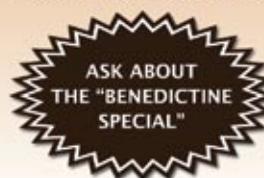

**HUNTINGTON CONDOMINIUMS**  
 20 S. Naper Blvd., Naperville, IL 60540  
 630.357.1720 - [www.naperville.com](http://www.naperville.com)

# Helpful Contact Information

## Emergency Numbers

Lisle Police Department: (630) 271-4200  
 Lisle Fire Department: (630) 964-9656  
 Benedictine University Police: (630) 829-6666  
 Edward Hospital (Naperville): (630) 527-3000  
 DuPage County Sheriff's Office: (630) 407-2400



## Campus Information

Benedictine University Police (non-emergency)	(630) 829-6122	<a href="mailto:msalantino@ben.edu">msalantino@ben.edu</a>
Early Alert Team	(630) 829-6006	<a href="mailto:mmasini@ben.edu">mmasini@ben.edu</a>
University Ministry	(630) 829-6033	<a href="mailto:rporo@ben.edu">rporo@ben.edu</a>
Enrollment Services (Ben Central)	(630) 829-6500	<a href="mailto:bencentral@ben.edu">bencentral@ben.edu</a>
Admissions	(630) 829-6300	<a href="mailto:admissions@ben.edu">admissions@ben.edu</a>
Athletics	(630) 829-6140	<a href="mailto:bsmith@ben.edu">bsmith@ben.edu</a>
Barnes & Noble Bookstore	(630) 829-6010	<a href="mailto:dbarnes@ben.edu">dbarnes@ben.edu</a>
Dining Services	(630) 829-6380	<a href="mailto:foodservices@ben.edu">foodservices@ben.edu</a>
Financial Aid	(630) 829-6100	<a href="mailto:financialaid@ben.edu">financialaid@ben.edu</a>
Parent Program	(630) 829-1127	<a href="mailto:hkeber@ben.edu">hkeber@ben.edu</a>
Student Health Services	(630) 829-6046	<a href="mailto:studenthealth@ben.edu">studenthealth@ben.edu</a>
Student Life	(630) 829-6006	<a href="mailto:mmasini@ben.edu">mmasini@ben.edu</a>
Student Success Center	(630) 829-6340	<a href="mailto:mcermak@ben.edu">mcermak@ben.edu</a>
Benedictine Library	(630) 829-6050	<a href="mailto:circdesk@ben.edu">circdesk@ben.edu</a>

## Academic College Offices

College of Business	(630) 829-6206	<a href="mailto:dssmith@ben.edu">dssmith@ben.edu</a>
College of Education and Health Services	(630) 829-6084	<a href="mailto:egeorge@ben.edu">egeorge@ben.edu</a>
College of Liberal Arts	(630) 829-6247	<a href="mailto:bshore@ben.edu">bshore@ben.edu</a>
College of Science	(630) 829-6187	<a href="mailto:cagomo@ben.edu">cagomo@ben.edu</a>
Moser College of Adult and Professional Studies	(630) 829-6289	<a href="mailto:dkazuba@ben.edu">dkazuba@ben.edu</a>

# Featured Sponsors

## BANKING & FINANCIAL SERVICES

**Campus Dough**  
 Please see ad on back cover.

## HOTELS & ACCOMMODATIONS

**Country Inn & Suites - Naperville**  
 Please see ad on p. 2.

**Courtyard by Marriott - Chicago Naperville**  
 Please see ad on p. 23.

**Harrison House Bed & Breakfast**  
 Please see ad on p. 27.

To be featured in the guide, please contact University Parent Media Sales Consultant Sharon Haddad at (866) 721-1357, or send an e-mail to [ask@universityparent.com](mailto:ask@universityparent.com).

## HOUSING & APARTMENTS

**Abbey Apartments on Four Lakes**  
 Please see ad on p. 27.

**Green Trails Apartments**  
 Please see ad on p. 2.

**Huntington Condominiums**  
 Please see ad on p. 29.

**Prentiss Creek Apartments**  
 Please see ad on p. 21.

**Tower at Four Lakes Apartments**  
 Please see ad on p. 2.

**Villages on Maple Apartments**  
 Please see ad on p. 15.

**Windscape of Naperville Apartment Homes**  
 Please see ad on p. 29.





Worried about  
how your student  
will manage  
money?

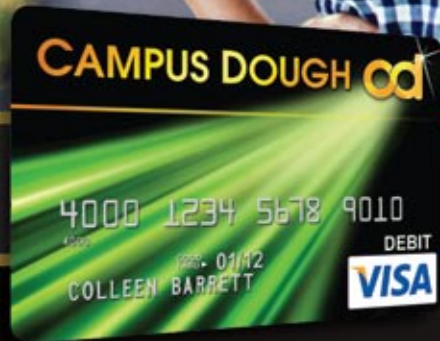

Check out the  
**CAMPUS DOUGH CARD!**

**The Best Way for Students to  
Manage & Save Money.**

[www.campusdough.com](http://www.campusdough.com)

**od**  
CAMPUS DOUGH

The Campus Dough DebitSmart Visa® Prepaid Card is issued by MetaBank™ pursuant to a license from Visa U.S.A. Inc. The USA PATRIOT Act is a Federal law that requires all financial institutions to obtain, verify, and record information that identifies each person who opens an account. You will be asked to provide your name, address, date of birth, and other information that will allow us to identify you. You may also be asked to provide documentation as proof of identification. "100% approval guaranteed" and "Everyone Qualifies" is contingent upon successfully passing the mandatory identification confirmation.